



LOWER PLATTE SOUTH natural resources district

3125 Portia Street | P.O. Box 83581 • Lincoln, Nebraska 68501-3581
P: 402.476.2729 • F: 402.476.6454 | www.lpsnrd.org

Memorandum

Date: February 11, 2025
To: Finance and Planning Subcommittee members
From: Mike Sousek, General Manager
RE: Finance and Planning Subcommittee Meeting Minutes

The Finance and Planning subcommittee met on Monday, February 10, 2025, at 5:00 PM via the online platform Zoom. Subcommittee members in attendance included committee chair Lisa Lewis, Deb Eagan, Seth Hawkins, Stephine Matejka, John Yoakum, and Ken Vogel. Absent subcommittee members included Chuck Hassebrook and Don Jacobson. Board Chair Bob Andersen was in attendance. Staff members included Dave Potter, Chris Barber, Drew Ratkovec, and Mike Sousek. No members of the public were present.

The agenda for the meeting consisted of one agenda item that required action followed by a discussion of budget/money management.

The first item dealt with a budget overrun on our Ash Hollow Channel project. Yost Excavating submitted a change order for installing a new vegetated rock swale and an additional rock slope for Station 40+25 in the amount of \$19,276. LPSNRD share would be \$6,425.33. LPSNRD's share of the change order will exceed the budget by \$6,425.33 for Ash Hollow-447081.

It was motioned by Ken Vogel, seconded by John Yoakum to recommend to the Board of Directors to approve the budget overrun for 447081-Ash Hollow in the amount of \$6,425.33. Recommendation carried unanimously.

A brief discussion on how to deal with future budget overruns followed. Staff introduced an issue that RF&W Subcommittee will be dealing with this month. Depending on that discussion, F&P subcommittee may be dealing with another budget overrun.

Meeting adjourned at 5:18PM

MJS

cc: Chair Andersen, Donna Reid, Dave Potter, Chris Barber, Drew Ratkovec



LOWER PLATTE SOUTH
natural resources district

3125 Portia Street | P.O. Box 83581 • Lincoln, Nebraska 68501-3581
P: 402.476.2729 • F: 402.476.6454 | www.lpsnrd.org

Memorandum

Date: February 4, 2025
To: Finance & Planning Subcommittee
From: Drew Ratkovec, Projects Coordinator 
Subject: Ash Hollow Channel Stabilization Budget Overrun

The LPSNRD, Lancaster County, and the City of Waverly have an Interlocal Agreement to split costs equally for maintenance and repair of the Ash Hollow Channel located west of Waverly, NE, near 134th Street and Salt Creek.

More recently Intuition and Logic was hired to design a solution for the erosion occurring in the channel with Yost Excavating being the low bid to perform the construction. A site visit took place in August 2024 to determine the state of the slope stabilization components that have been constructed thus far. Erosion issues were occurring at Station 40+25, and it was decided to have Intuition & Logic design a vegetated rock swale for the fix. Yost Excavating submitted a change order for installing a new vegetated rock swale and an additional rock slope for Station 40+25 in the amount of \$19,276. LPSNRD share would be \$6,425.33.

LPSNRD's share of the change order will exceed the budget by \$6,425.33 for Ash Hollow-447081, causing a request for a budget overrun.

It is staff recommendation to the F&P subcommittee **to recommend that the Board of Directors approve the budget overrun for 447081-Ash Hollow in the amount of \$6,425.33.**

**LANCASTER COUNTY ENGINEERING DEPARTMENT
SUPPLEMENTAL AGREEMENT**



Change Order No. 5

Date: 12/20/2024

Contractor: Yost Excavation
Project No. 21-61 **Bid No.** 23-257
Contract No. C-23-0983 **Contract Date:** 12/19/2023 **Description:** Ash Hollow Waverly Channel Stabilization

WE HEREBY REQUEST APPROVAL OF CHANGES IN THE PLANS, SPECIFICATIONS, OR WORK NOT INCLUDED IN THE PLANS OR CONTRACT DESCRIBED AS FOLLOWS:

Install a new vegetated rock swale and an additional rock slope at Station 40+25 due to erosion issues on site. This will be an increase to the contract of \$19,276 (from \$876,872 to \$896,148).

ESTIMATED CHANGES IN QUANTITIES OF ITEMS OF WORK AT CONTRACT OR AGREED UNIT PRICES						
ITEM OF WORK	UNIT	INCREASED QUANTITY	DECREASED QUANTITY	CONTRACT UNIT PRICE	AGREED UNIT PRICE	INCREASED (+) OR DECREASE (-)
SP-13 Excavation	CY	100		\$ 14.25		\$ 1,425.00
SP-18 D90= 24" Rock Toe Protection	CY	11		\$ 165.00		\$ 1,815.00
SP-19 D90= 12" Rock Slope with 6" Sp	CY	14		\$ 296.00		\$ 4,144.00
SP-20 Vegetated Rock Swale	CY	20		\$ 324.00		\$ 6,480.00
SP-21 4" Thick Granular Backfill	CY	8		\$ 129.00		\$ 1,032.00
Tree Removal and Minor Clearing	LS	1			\$ 1,500.00	\$ 1,500.00
Hauling Cost Differential for Partial Loads	LS	1			\$ 2,880.00	\$ 2,880.00
						\$ -
TOTAL NET INCREASE (+) or DECREASE (-)						\$ 19,276.00

For and in consideration of the prices set forth in this agreement, the Contractor agrees to complete the extra and additional work or reduced quantities of work described herein and accept the prices shown as full payment. The insurance, bond and items of the contract remain in full effect, except as specifically changed herein, and shall apply to this agreement.

Contractor's Representative (Printed Name)

Contractor's Representative (Signature) Date:

Larry Legg, Project Engineer Date:

Executed this _____ day of _____, 2024
Lancaster County Board of Commissioners

Pam Dingman, County Engineer Date:

Approved as to form this _____ day
of _____, 2024

Lancaster County Attorney

CONSTRUCTION CHANGE ORDER

No. CO-005

SUBJECT: ADDITIONAL ROCK SWALE

DATE OF ISSUANCE 12-20-2024 EFFECTIVE DATE 12-20-2024

OWNER Lancaster County Nebraska

CONTRACTOR Yost Excavating, Inc.

PROJECT: Ash Hollow Channel Stabilization

ENGINEER Intuition and Logic Engineering Inc.

You are directed to make the following changes in the Contract Documents:

Description: Install a new vegetated rock swale and an additional rock slope at Station 40+25.

Reason for Change Order: Modifications to address erosion issues observed on site.

Response: Plans and quantities have been modified to reflect these changes.

This change order results in a \$19,276.00 cost increase (from \$876,872.00 to \$896,148.00) associated with the additional work.

Attachments:

- Modified Plan Sheets
 - C-204 Plan and Profile
 - C-502 Planting Plan
 - C-503 Planting Plan

RECOMMENDED:

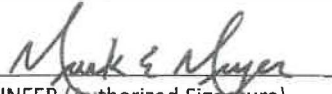
By: 
ENGINEER (Authorized Signature)

Date: 12-20-2024

It is by LOGIC that we prove
but by INTUITION that we discover

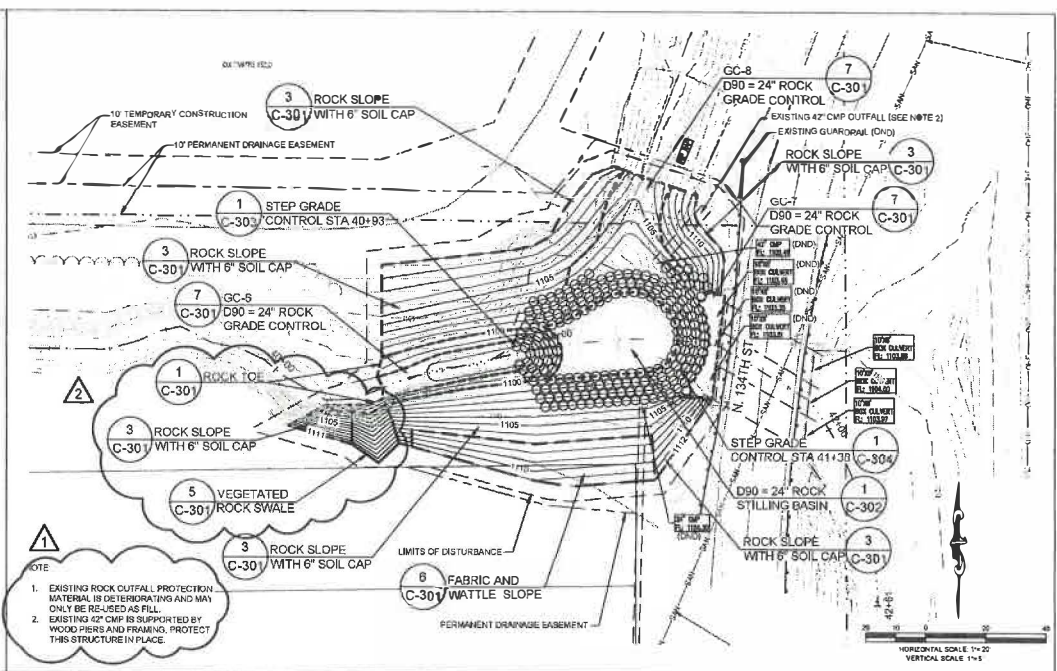
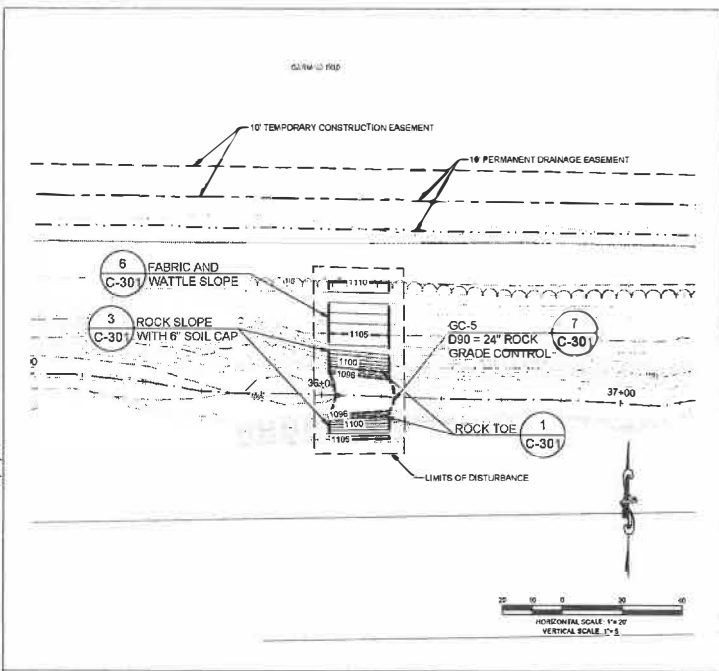

- NOTE
- EXISTING ROCK CUTFALL PROTECTION MATERIAL IS DETERIORATING AND MAY ONLY BE RE-USED AS FILL.
 - EXISTING 42' CMP IS SUPPORTED BY WOOD PIERS AND FRAMING. PROTECT THIS STRUCTURE IN PLACE.

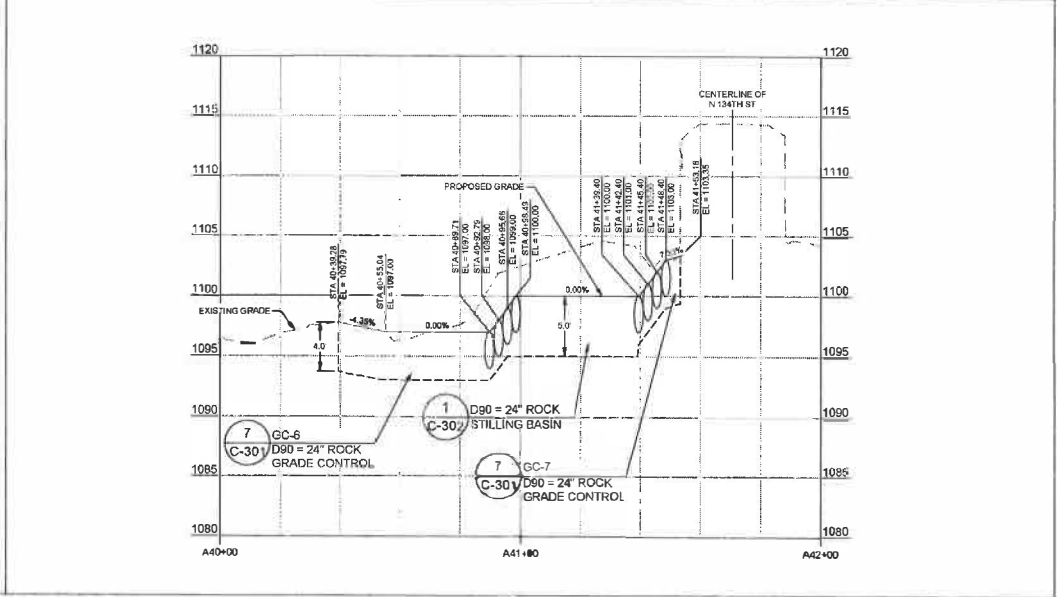
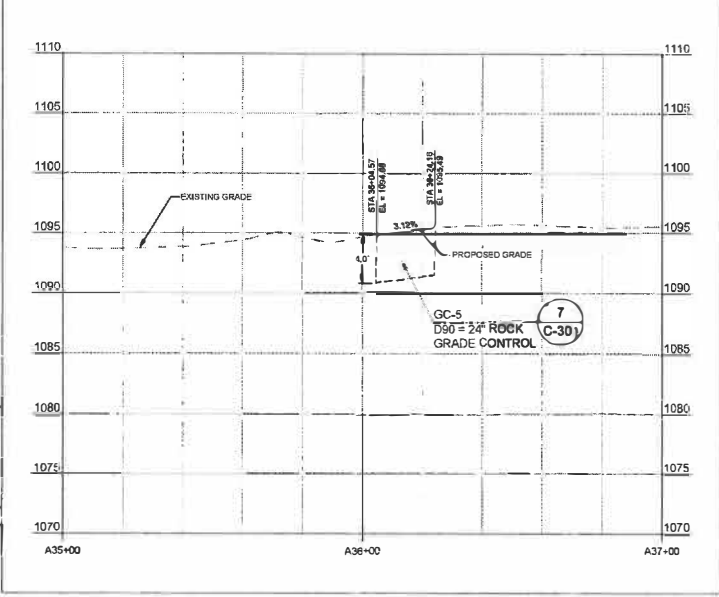

INTUITION
 Intuition Engineering, Inc.
 1000 S. 10th Street, Suite 100
 Lincoln, NE 68502
 Phone: (402) 477-2000

ASH HOLLOW CHANNEL STABILIZATION
 Lancaster County, Nebraska

Professional Engineer Seal
 Mark Edward Meyer - Engineer
 E-11103



Tab	Date	Description
1	2/16/2024	CHANGE ORDER 3
2	12/19/2024	CHANGE ORDER 3

Date: OCT 28, 2025
 Drawn by: JDF
 Design by: MBW
 Checked by: TFD
 Prepared by: JDF

PROJECT NO. 2214

SHEET TITLE:
 PLAN AND PROFILE

SHEET NUMBER:
 C-204

C-500_2214_LC_AshHollow_Planting_004

12/19/24

Path: P:\2214 - LANCASTER COUNTY - Ash Hollow Channel Construction\Change Orders and Clarifications\2024-10-29 CO4 Additional Rock Slope\CAD\Plans
Plotter: on: 12/19/24 @ 4:17:44 PM by: JENALSTONBAUGH

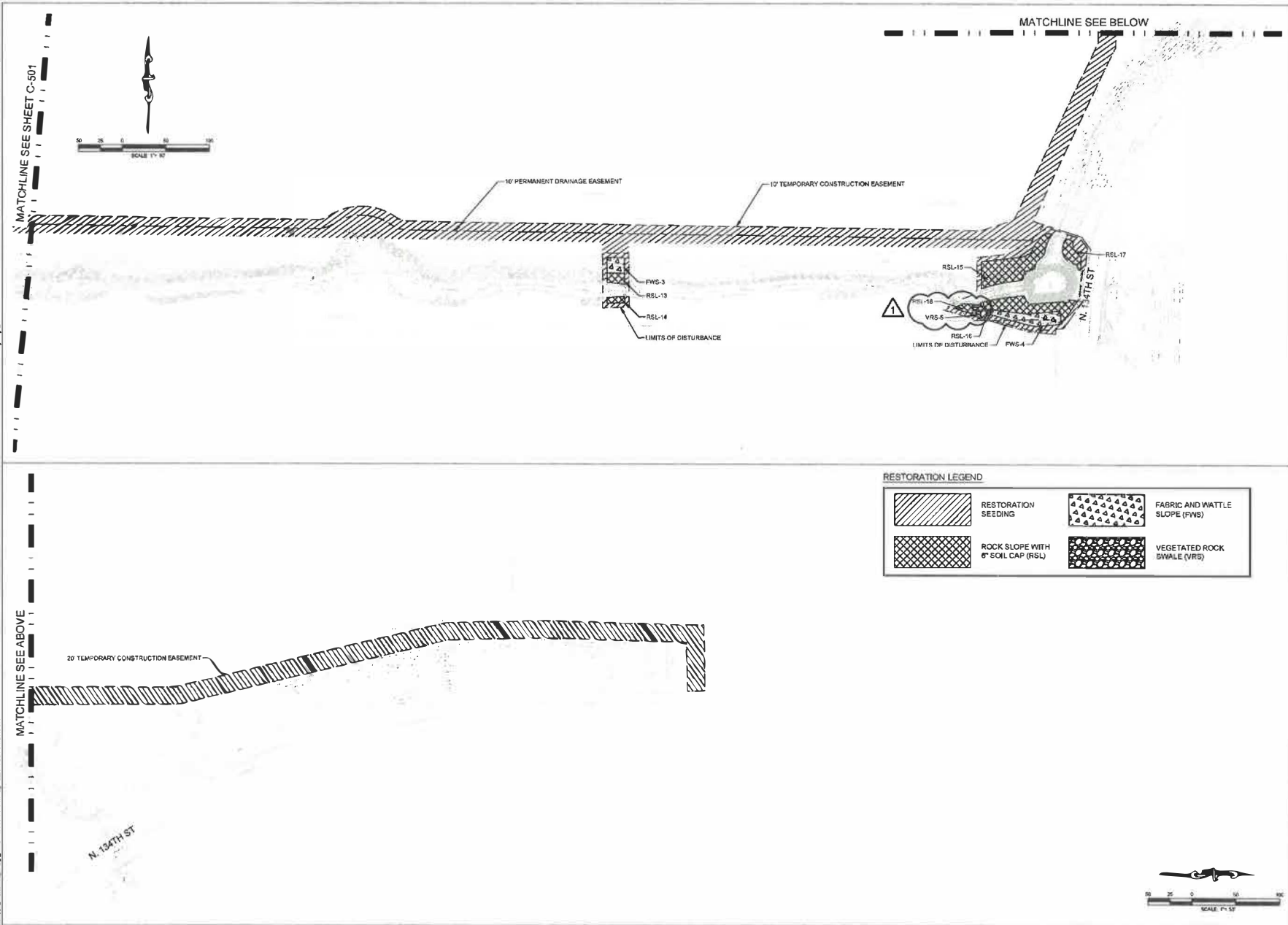

RESTORATION LEGEND

	RESTORATION SEEDING		FABRIC AND WATTLE SLOPE (FWS)
	ROCK SLOPE WITH 6" SOIL CAP (RSL)		VEGETATED ROCK DIKE (VRS)

INTUITION
 Intuition Landscape Architecture, Inc.
 2000 23rd St, Suite 101
 Lincoln, NE 68503
 Phone: (402) 477-3300

ASH HOLLOW CHANNEL STABILIZATION
 Lancaster County, Nebraska

Professional Engineer: Seal
 Mark Edward Meyer - Engineer
 E-11103

Expiration Date: DEC. 31, 2026

Rev.	Date	Description
1	12/19/2024	CHANGE ORDER 3

Date: OCT 26, 2020
 Drawn by: JDF
 Design by: WCM
 Checked by: TPC
 Approved by: WCM

PROJECT NO. 2214

SHEET TITLE
 PLANTING PLAN

SHEET NUMBER
 C-502

B-500_2214_LC_AshHollow_PLANTING.CDW

12/17/24

Path: P:\2214 - LANCASTER COUNTY - Ash Hollow Channel Construction\Change Order and Clarifications\2024-10-29 CO4 Additional Rock Slope\CAD\Plans Plotted: 01/13/25 @ 4:17:55 PM by: EDNA STOMBAUGH

Livestakes			RSL-1	RSL-2	RSL-3	RSL-4	RSL-5	RSL-6	RSL-7	RSL-8A	RSL-8B	RSL-9	RSL-10	RSL-11	RSL-12	RSL-13	RSL-14	RSL-16	RSL-16	RSL-17	VRS-1	VRS-2	VRS-3	VRS-4	Total	
Botanical Name	Common Name	Form	Spacing on Center (ft)																							
			Quantity	Quantity	Quantity	Quantity	Quantity	Quantity	Quantity	Quantity	Quantity	Quantity	Quantity	Quantity	Quantity	Quantity	Quantity	Quantity	Quantity	Quantity	Quantity	Quantity	Quantity	Quantity	Quantity	Quantity
<i>Cephalanthus occidentalis</i>	Burambush - Sugar Shuck	48 livestock	2	94	60	81	45	52	44	42	61	53	50	28	55	66	19	13	127	103	28	92	28	24	10	1234
<i>Cornus alternifolia</i>	Roughleaf dogwood	48 livestock	2	75	72	85	36	42	35	34	49	42	64	21	44	53	15	10	102	82	23	74	23	19	8	988
<i>Cornus sericea</i>	Redosier dogwood	48 livestock	2	58	54	49	27	31	27	25	37	32	48	16	33	40	11	8	78	62	17	55	16	14	6	742
<i>Salix amygdaloides</i>	Prairie willow	48 livestock	2	36	38	33	16	21	18	17	25	21	32	11	22	27	8	5	51	41	12	37	12	10	4	489
<i>Sambucus canadensis</i>	Elkberry	48 livestock	2	112	107	97	54	62	53	50	73	83	86	32	66	79	22	15	152	123	34	110	35	26	12	1476
TOTAL			375	359	325	180	208	177	188	245	211	320	108	220	265	75	81	608	411	114	368	117	96	40	4938	

NOTES
 1. Plant species randomly throughout area.
 2. Apply restoration seed mix under erosion control blanket to all Rock Slope with 8" Soil Cap areas.

Fabric and Wet Slope			FWS-1	FWS-2	FWS-3	FWS-4	Total	
Botanical Name	Common Name	Form	Spacing on Center (ft)					
			Quantity	Quantity	Quantity	Quantity	Quantity	
<i>Aster sp. Indigo</i>	Shrub Indigo	Bare root	4	15	12	4	10	41
<i>Cephalanthus occidentalis</i>	Burambush - Sugar Shuck	Bare root	4	20	16	5	13	64
<i>Populus deltoides</i>	Eastern cottonwood	Bare root	4	5	4	2	4	16
<i>Quercus velutina</i>	Black oak	Bare root	4	15	12	4	10	41
<i>Sambucus canadensis</i>	Elkberry	Bare root	4	15	12	4	10	41
<i>Symphoricarpos racemiflorus</i>	Snowberry	Bare root	4	20	16	5	13	64
<i>Taxodium distichum</i>	Bald cypress	Bare root	4	10	8	3	7	28
TOTAL			100	60	27	67	274	

NOTES
 1. Plant species randomly throughout area.
 2. Do not plant Eastern Cottonwood, Bald Cypress, or Black Oak within 10 ft of subarea or pipes.
 3. Apply restoration seed mix under erosion control blanket to all Fabric and Wet Slope areas.

Combined Plant Palette			
Botanical Name	Common Name	Form	Quantity
<i>Cephalanthus occidentalis</i>	Burambush - Sugar	48 livestock	1234
<i>Cornus drummondii</i>	Roughleaf dogwood	48 livestock	988
<i>Cornus sericea</i>	Redosier dogwood	48 livestock	742
<i>Salix amygdaloides</i>	Prairie willow	48 livestock	499
<i>Sambucus canadensis</i>	Elkberry	48 livestock	1475
<i>Amorpha fruticosa</i>	Shrub Indigo	Bare root	41
<i>Cephalanthus occidentalis</i>	Burambush - Sugar	Bare root	54
<i>Populus deltoides</i>	Eastern cottonwood	Bare root	15
<i>Quercus velutina</i>	Black oak	Bare root	41
<i>Sambucus canadensis</i>	Elkberry	Bare root	41
<i>Symphoricarpos occidentalis</i>	Snowberry	Bare root	54
<i>Taxodium distichum</i>	Bald cypress	Bare root	28
Grand Total			5212

THE RESTORATION SEED MIX SHALL BE TYPE "E" - LOW GROWING GRASS MIX (OUTLYING CITY AND ACREAGES) AS SPECIFIED IN THE 2023 CITY OF LINCOLN STANDARD SPECIFICATIONS ARTICLE 30.04

Livestakes			RSL-16	VRS-6	Total	
Botanical Name	Common Name	Form	Spacing on Center (ft)			
			Quantity	Quantity	Quantity	
<i>Cephalanthus occidentalis</i>	Burambush - Sugar Shuck	48 livestock	2	16	17	33
<i>Cornus alternifolia</i>	Roughleaf dogwood	48 livestock	2	13	14	27
<i>Cornus sericea</i>	Redosier dogwood	48 livestock	2	10	10	26
<i>Salix amygdaloides</i>	Prairie willow	48 livestock	2	7	7	14
<i>Sambucus canadensis</i>	Elkberry	48 livestock	2	19	20	39
TOTAL			65	68	133	

NOTES
 1. Plant species randomly throughout area.
 2. Apply restoration seed mix under erosion control blanket to all Rock Slope with 6" Soil Cap areas.



INTUITION
 Nebraska Landscaping & Nursery
 4002 S. 24th St.
 Lincoln, NE 68503
 Phone: (402) 491-7700

ASH HOLLOW CHANNEL STABILIZATION
 Lancaster County, Nebraska

Professional Engineer Seal
 Mark Edward Meyer - Engineer
 E-11163



Expiration Date: DEC. 31, 2026

Rev	Date	Description
1	10/13/2024	CHANGE ORDER 5

Date: OCT 26, 2023
 Quantity: 201
 Design by: MDA
 Checked by: TMS
 Prepared by: MDA

PROJECT NO. 2214

SHEET TITLE
 PLANTING PLAN

SHEET NUMBER
 C-503

AGREEMENT

THIS AGREEMENT made and entered into the 5th day of JANUARY, 1982, by and between the City of Waverly, Nebraska, hereinafter referred to as "Waverly"; the County of Lancaster, Nebraska, hereinafter referred to as "Lancaster"; and the Lower Platte South Natural Resources District, hereinafter referred to as "LPS".

WHEREAS, the parties hereto have previously entered into an Agreement, dated February 21, 1979, for the construction of the project known as the Ash Hollow Drainway; and

WHEREAS, paragraph 5 of said Agreement provides as follows:

After completion, Lancaster Will be responsible for routine maintenance of the improved and relocated Ash Hollow Drainway north of the CB&Q Railroad. Maintenance other than routine will be mutually agreed upon by the parties; and

WHEREAS, the parties now wish to clarify their respective responsibilities in regard to maintenance of said project.

NOW, THEREFORE, in consideration of the mutual covenants, promises contained herein it is agreed as follows by the parties hereto:

1) For purposes of the above-referenced paragraph 5 of the Agreement of February 21, 1979, the term "routine maintenance" shall mean that maintenance that can be performed by laborer only without the use of heavy equipment. Maintenance necessitated by serious erosion or blockage of any portion of the channel or maintenance requiring the use of heavy equipment shall not be considered routine maintenance.

2) In the event that maintenance other than routine maintenance is required, the following procedure shall be employed:

- a) The Lancaster County Engineer's Office, upon becoming aware of the need for such maintenance shall immediately take the necessary action to have the maintenance performed and shall contact Waverly and LPS by mail of the need for such maintenance, the general nature of the maintenance required and the approximate cost of such maintenance. The cost of such maintenance shall be shared equally by the parties.

EXECUTED by the CITY OF WAVERLY this 7 day of December, 1981.



ATTEST: [Signature]

CITY OF WAVERLY, NEBRASKA

BY: [Signature]
Title

EXECUTED by the LOWER PLATTE SOUTH NATURAL RESOURCES DISTRICT this 21st day of December, 1981.

LOWER PLATTE SOUTH NATURAL RESOURCES DISTRICT

BY: [Signature]
Chairman

EXECUTED by THE COUNTY OF LANCASTER, NEBRASKA, this 5th day of JANUARY, 1981.

BY THE BOARD OF COUNTY COMMISSIONERS OF LANCASTER COUNTY, NEBRASKA

APPROVED AS TO FORM THIS 5th DAY OF Jan, 1981.

[Signature]
MICHAEL G. HEAVICAN
Chief Deputy County Attorney

[Signature]
[Signature]
Joseph R. Edwards

MGH/MET/jh
10/6/81